

TX-32



LED 

A 32" LED-backlit multi-touch display constructed with advanced optical touch technology and NeoV™ Touch Glass for various high-traffic and interactive environments.

Emphasising its versatility and durability, the TX-32 multi-touch display is engineered with advanced optical touch technology that provides 6-point touch with accurate and zero-pressure response from pointing objects. On top of internal HeatControl Sensor, a wide range of connectivity and programmable scheduler allow various digital signage applications. Its maximum lifespan and minimum maintenance are guaranteed thanks to the anti-fingerprint NeoV™ Touch Glass that protects the panel against scratches. Together with a robust metal housing and Anti-Burn-in™ technology, the TX-32 is designed to provide superior touch performance in high-traffic public environments.

- > Incorporates advanced optical touch technology
- > 6-point touch capability for systems with Microsoft® Windows® 7 and 8 support plug and play
- > 2-point touch capability for system with Microsoft® Windows® Vista, 6-point touch capability for systems with Mac OS 10 and above support by driver
- > Single touch point capability for system with Android 4.0+ support plug and play, for systems with Microsoft® Windows® XP, Linux, Mac OS 9 and below support by driver
- > LED-backlit technology with 1920 x 1080 Full HD resolution
- > NeoV™ Touch Glass prevents the screen from fingerprints
- > Anti-Burn-in™ technology
- > AIP technology: PIP/PBP function; 3D Comb Filter / Deinterlace / Noise Reduction
- > EcoSmart Sensor detects ambient lighting condition and automatically adjusts brightness level to reduce power consumption
- > Versatile connectivity (VGA in/out, DVI in/out, HDMI, DisplayPort, BNC in/out, S-Video, Component, Audio in/out)
- > Built-in Scheduler allows different scheduled activations
- > Tiling function for easy video wall setup (supports up to 5 x 5, available in non-touch mode)
- > Flexible display orientation: portrait/ landscape
- > HeatControl Sensor prevents the display from overheating
- > RS-232 (in/out) and RJ45 for display control from a remote location
- > Built-in speakers
- > Durable metal housing
- > Rigorous screening of the components for mission-critical 24/7 applications



NeoV™ Touch Glass - The most trusted hard glass protection available.



TX-32

Specifications

TX-32

Panel	Panel Type	LED-Backlit TFT LCD (MVA Panel)
	Panel Size	31.5"
	Max. Resolution	FHD 1920 x 1080
	Refresh rate	60 Hz
	Pixel Pitch	0.3637 mm
	Brightness	350 cd/m ² (Typical)
	Contrast Ratio	3000 : 1 (Typical)
	Viewing Angle (H/V)	178°/178°
	Display Colour	16.7 M
Response Time	8 ms (GTG)	
Frequency (H/V)	H Freq.	30 kHz - 75 kHz
	V Freq.	50 Hz - 75Hz
Input	VGA	15-Pin D-Sub
	DVI	24-Pin DVI-D
	S-Video	4-Pin mini DIN
	Component (YPbPr)	RCA
	HDMI	HDMI x 2
	CVBS	BNC
	DisplayPort	DisplayPort
Output	VGA	15-Pin D-Sub
	DVI	24-Pin DVI-D
	CVBS	BNC
External Control	RS-232 in/out	9-Pin D-Sub
	RJ45	RJ45
Audio	Audio In	1 x stereo audio in for PC (audio jack, 3.5 Ø) 1 x stereo audio in (RCA)
	Audio Out	1 x stereo audio out (RCA)
	Internal Speaker	10W x 2
	External Speaker Out	10W x 2
Touch Screen	Technology	Optical
	Positional Accuracy	± 3.0 mm 100% of touchable active area
	Active Force	Non-required
	Panel Interface	USB (Type-B, HID compliant)
Power	Power Supply	Internal
	Power Requirements	100 - 240V, 50-60Hz
	Consumption	< 85 W (On) < 0.5 W (Stand-by) < 0.5 W (Off)
NeoV™ Touch Glass	Thickness	3.0mm (0.18")
	Gloss	100GU
	Transmission Rate	> 92%
	Coating Hardness	> 8H
Operating Conditions	Temperature	0°C ~ 40°C (32°F~104°F)
	Humidity	10% ~ 80% (No condensation)
Mounting	VESA FPMPMI	Yes (400 x 200mm)
Dimensions	w/o Base (W x H x D)	750 x 447 x 101.8 mm (29.5" x 17.6" x 4")
	w/o Base Packaging (W x H x D)	870 x 624 x 249 mm (34.3" x 24.6" x 9.8")
Weight	Product Weight	17.6 kg (38.7 lbs)
	Packaging Weight	20.9 kg (46.0 lbs)
Regulation Approval	Certifications & Compliance	FCC, CB, CE, CEL, CCG, BSMI, RoHS, GOST-R, WEEE, REACH
Accessories	Supplied	15-Pin D-Sub cable, USB cable, power cord, remote control, batteries



NeoV™ Touch Glass keeps the screen protected and looking new

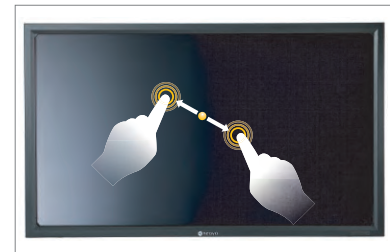

Advanced optical touch technology for accurate, zero-pressure response multi-touch gestures



Anti-Burn-in™ technology prevents image sticking



Multiple video inputs (VGA, DVI, HDMI, BNC, S-Video, DisplayPort and Component) allow for effortless system integration

